

Assembly Instruction

FLOATING SHELF

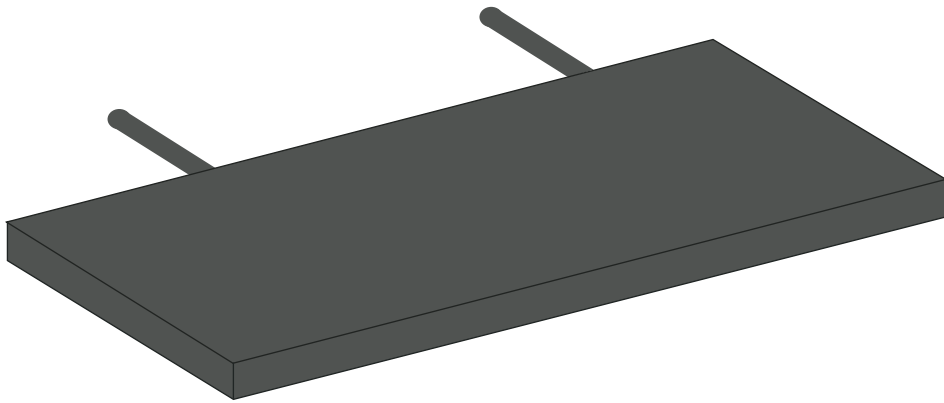

Dear family bed sleepers,

by selecting a product from RIMA GmbH, you have made an excellent decision. It is important that you carefully read and follow the assembly instructions provided to ensure proper use of the product.



WOOD - A NATURAL PRODUCT

Wood is a natural material that is affected by the humidity of the surrounding air. With careful maintenance, you will enjoy your family bed for many years.



CHECKING THE LIST OF PARTS

Before you start assembling, please check the completeness of the components according to the parts list.



FINALLY

Please be aware that we may make technical modifications. We now wish you lots of fun and success assembling your bed and many peaceful nights in your family bed.



GENERAL INFORMATION:

Assembly time approx. 30 minutes (1 person)

To ensure safety, please note that the shelf should only be fixed onto a brick or concrete wall. Additionally, please note that the maximum weight the shelf can hold is 40 kg.

ATTENTION: NOT suitable for wallboard, plasterboard, and gypsum fibreboard walls.

SOMETHING DOESN'T WORK?



Mistakes happen!

Although we try very hard, it can happen that something doesn't work out. If items, packages or components are missing or damaged in your delivery, please let us know the item or package number so we can quickly allocate them and send you a replacement without delay.



office@familienbett.at



+43(0) 3612 / 250 25



CHECKING THE LIST OF PARTS

Included are the following wooden elements:

(DE) Paket **1/1** - Wandboard + Beschläge

(EN) Package 1/1 - Wall shelf + fittings

* 1 - Wooden board (90 x 20 x 3 cm)

* Fittings

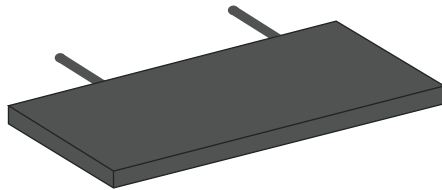

Paket 1/1



CHECKING THE LIST OF PARTS

The following fittings are included:



2 - Wall brackets

1

CHECK THE INSTALLATION AREA FOR CONDUCTORS/CABLES.



Before drilling, it is essential to ensure no pipes or electric lines are in the wall where you plan to place the shelf. Drilling into them can cause damage. Power lines are typically located above sockets and light switches. To avoid drilling into any wiring, check the wall beforehand. You can use a locating device to find gas pipes, water pipes, and power lines. Ideally, choose a location for your wall shelf that is entirely free of pipes.

2

CHECK THE INSTALLATION AREA FOR CONDUCTORS/CABLES.

When deciding where to place your wall shelf, think about how often you will need to access the items on it. Mount the shelf at a height that is comfortable for you to reach so that you can easily get to the items you need.



3

MARKING THE POSITION OF THE SHELF

To position the shelf on the wall, hold it where you want it first. Then, use a spirit level to mark the spot accurately.

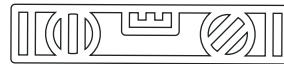

4

MOUNTING THE BRACKETS

1. Mark the drill holes and check with the spirit level again.
2. Drill (12mm diameter) and tighten the screws.
3. Put the shelf onto the brackets.

